

INST_12_35



Nr. 13

Nr. 4, 5

Nr. T30

1

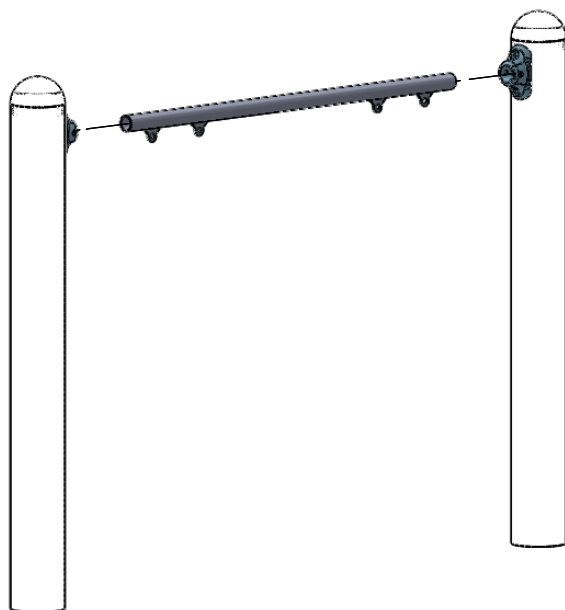

2

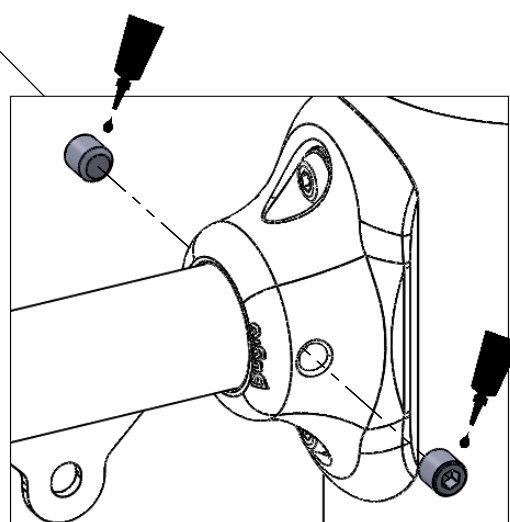
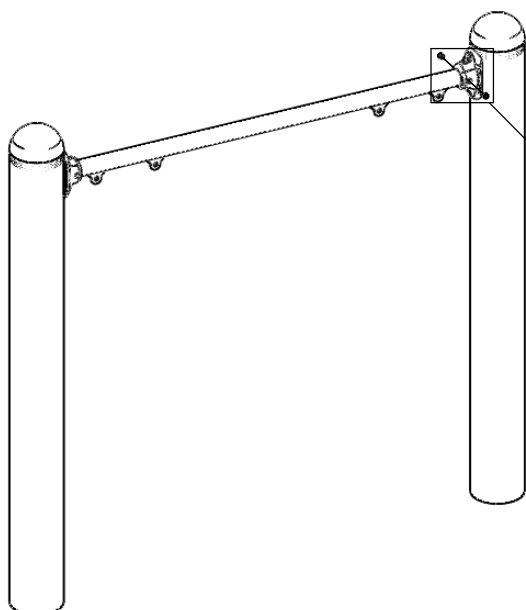

Nr	Σ	Element		
2	2		-	W6x60
21	6		DIN 125	8x16
22	4		DIN 125	6x12
24	4		ISO 7380	M6x16
43	2		DIN 1587	M8
58	1		-	LOCTITE
84	2		ISO 7380	M8x35
88	1		-	ALUZ RR
124	2		DIN 7991	M6x20
147	6		-	M6x10

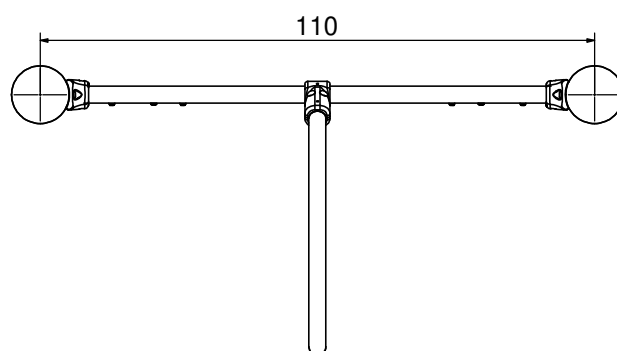

3

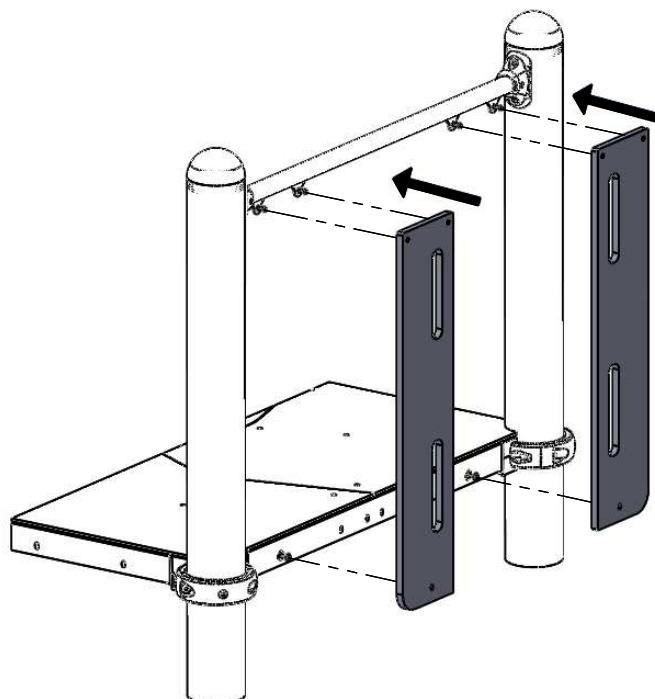

4

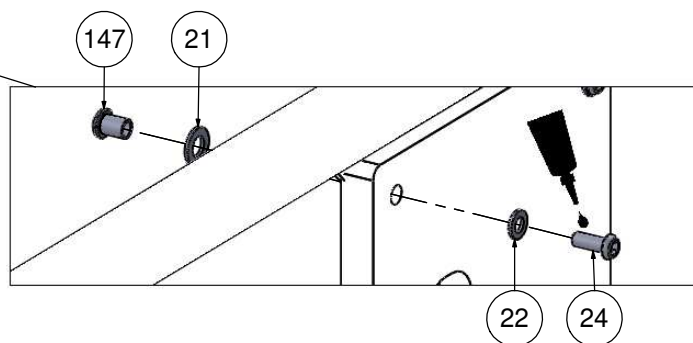
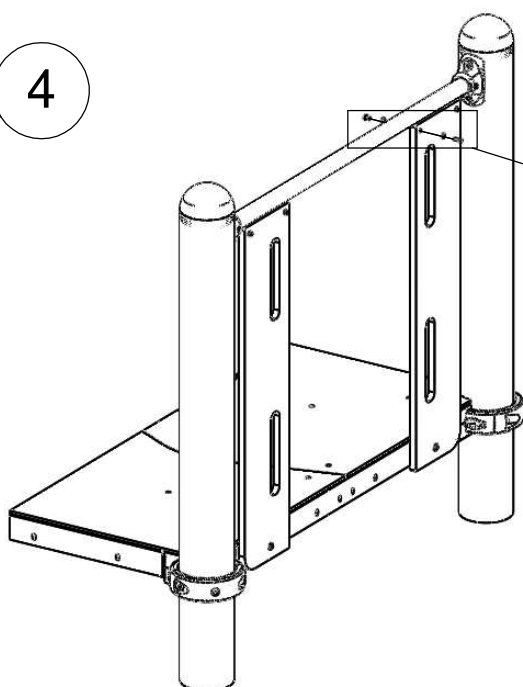

5

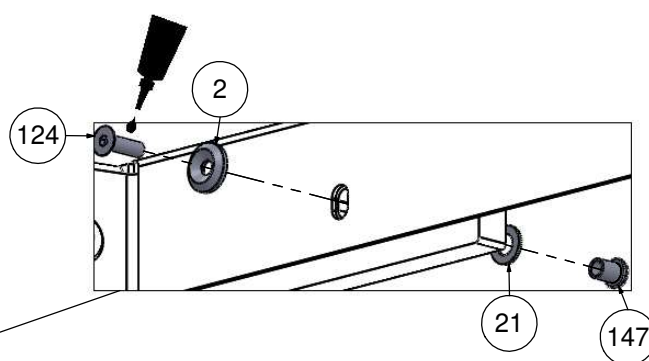
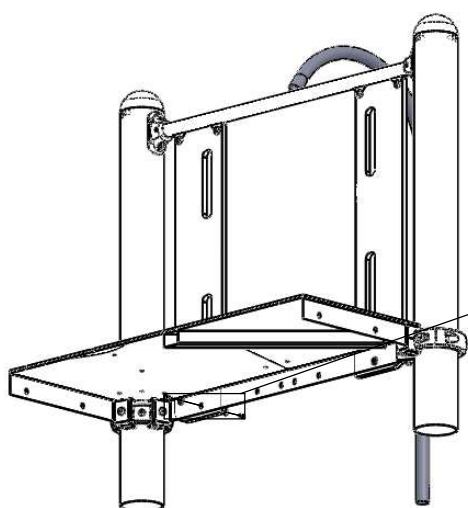

6

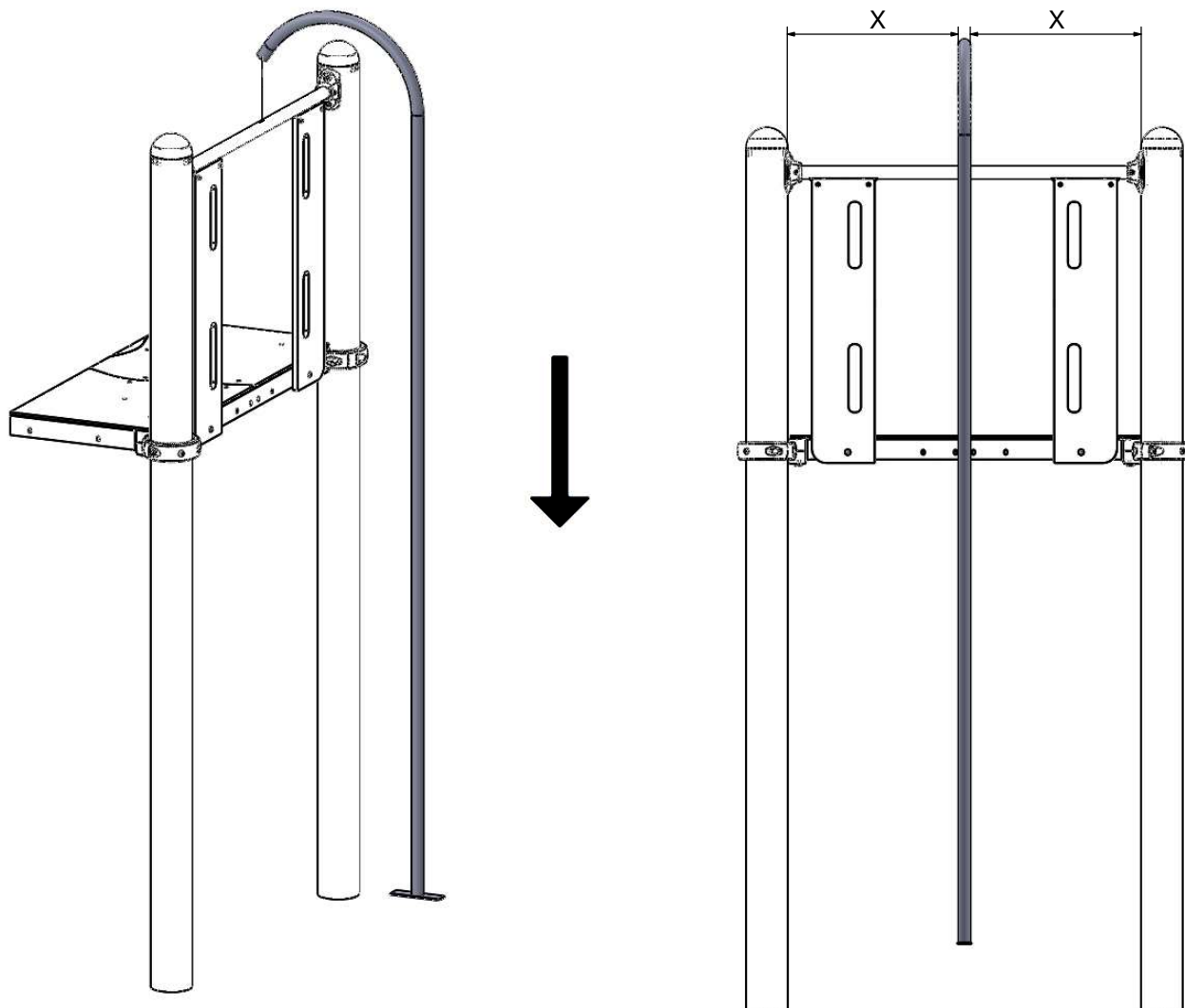

7

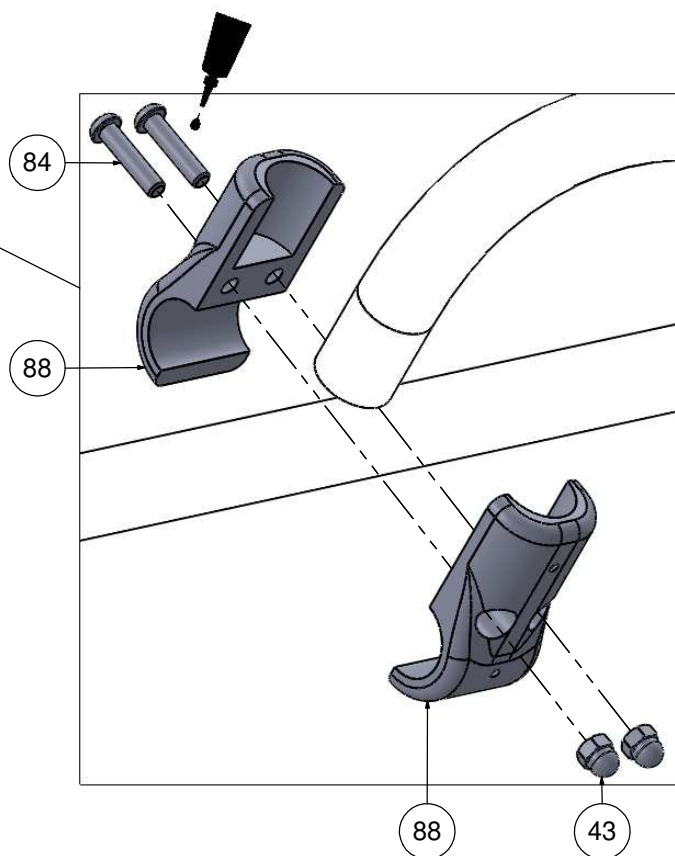
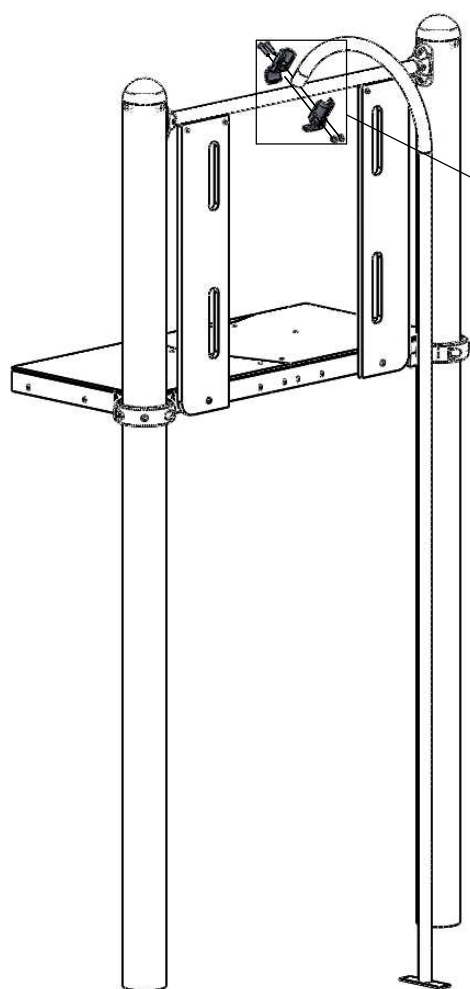

8 F

Nr	Σ	Element		
61	1		-	KL105

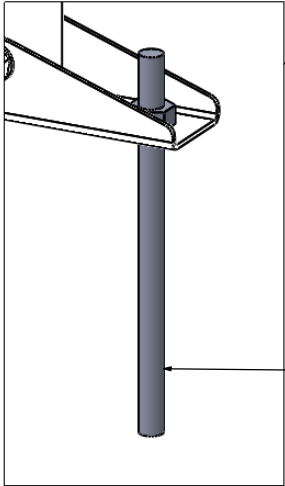
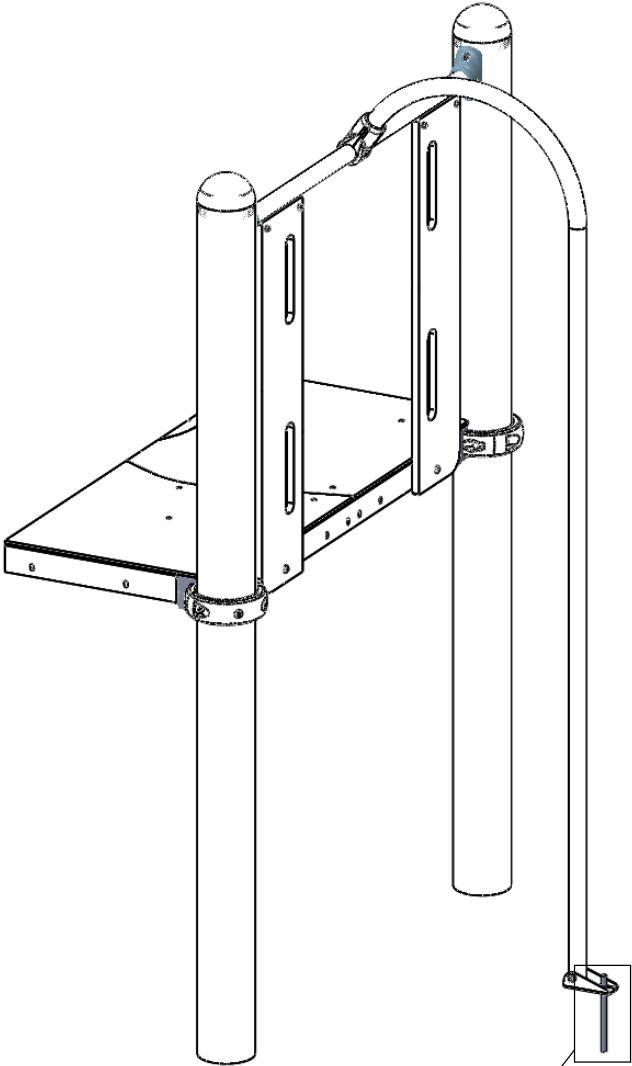

61